

CONCRETE BREAKWATER TYPE SF 300, 400, 500

The geometry of this pontoon, in combination with our patented coupling and an advanced mooring system, makes our floating breakwater an excellent wave attenuator.

These pontoons have been developed over many years and today there are numerous reference installations in use around the world.

SF MARINA breakwaters are all-concrete pontoons with all the advantages of high stability and buoyancy.

The concrete and Styrofoam construction of the pontoon produces very high buoyancy and makes it virtually unsinkable.

Using high quality materials, coupled with a quality manufacturing process, the pontoon enjoys a long design life.

Standard pontoons are designed to accept electrical and water supply services.

Normally, the pontoons would be moored using chains and blocks.

These pontoons are designed to be used as floating breakwaters.

however, they can be used wherever a pontoon of high stability and freeboard is needed.

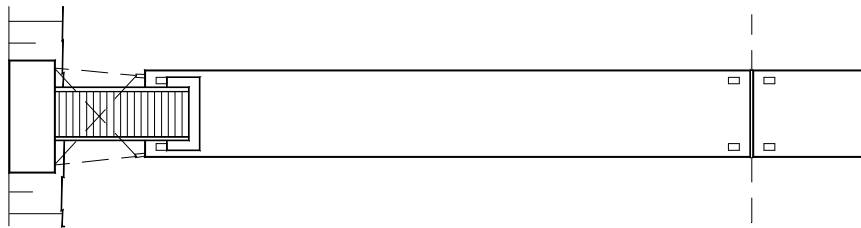

DATA TYPE SF 300

DATA TYPE SF 400

DATA TYPE SF 500

The pontoon is manufactured in accordance with the Swedish Concrete Standards BBK 94

Length: 20.0 m.
Width: Incl. fender 3.25 m.
Width: Excl. fender 3.0 m.
Height: 1.8 m.
Weight: 38.0 ton.
Freeboard: Approx. 0.55 m.
Buoyancy: Approx. 35 ton.
Connectors: 2 units type W 300 per joint.
Breaking load: W 300: 2x60 ton per joint.

Length: 20.0 m.
Width: Incl. fender 4.25 m.
Width: Excl. fender 4.0 m.
Height: 1.8 m.
Weight: 53 ton.
Freeboard: Approx. 0.55 m.
Buoyancy: Approx. 45 ton.
Connectors: 2 units type W 400 per joint.
Breaking load: W 400: 2x90 ton per joint.

Length: 20.0 m.
Width: Incl. fender 5.25 m.
Width: Excl. fender 5.0 m.
Height: 1.8 m.
Weight: 62 ton.
Freeboard: Approx. 0.55 m.
Buoyancy: Approx. 60 ton.
Connectors: 2 units W 500 per joint.
Breaking load: W 400: 2x90 ton per joint.

All-concrete pontoons: Concrete: K40. Air 6%. $W_{cr} \leq 0.4$. Reinforcement: Nps 500, Ks 500, Ks 600. Styrofoam: min. 65kPa.

Cast-in materials: Stainless or hot-dipped galvanised steel. Wood fender: Pressure-treated pine 95 x 145 mm.

Other dimensions can be offered upon request. Rights reserved for alterations.

